

PUBLIC PATH DIVERSION AND DEFINITIVE MAP AND STATEMENT MODIFICATION ORDER

HIGHWAYS ACT 1980

WILDLIFE & COUNTRYSIDE ACT 1981

STAFFORDSHIRE COUNTY COUNCIL

**PUBLIC BRIDLEWAY NO.0.1517 (PART) HIGH OFFLEY PARISH
PUBLIC PATH DIVERSION AND DEFINITIVE MAP AND
STATEMENT MODIFICATION ORDER 2016**

This order is made by Staffordshire County Council ("the authority") under Section 119 of the Highways Act 1980 ("the 1980 Act") because it appears to the authority that in the interests of the owners of the land crossed by the bridleway as described in paragraph 1 of this Order, it is expedient that the line of the path should be diverted.

This Order is also made under Section 53A (2) of the Wildlife & Countryside Act 1981 (the 1981 Act") because it appears to the authority that the Definitive Map and Statement for the Borough of Stafford requires modification in consequence of the occurrence of an event specified in Section 53(3) (a) (i) of the 1981 Act, namely the diversion (as authorised by this Order) of highways shown or required to be shown in the Map and Statement.

The landowner has agreed to defray any expenses which are incurred in bringing the new site of the path into a fit condition for use by the public.

Stafford Borough Council has been consulted as to the making of the Order as required by Section 120(2) of the 1980 Act.

BY THIS ORDER

1. The public bridleway over the land situated at High Offley and shown by a bold continuous line on the map contained in this Order and described in part 1 of the Schedule to this Order shall be stopped up after 28 days from the date of confirmation of this Order, and thereupon the Definitive Map for the Borough of Stafford shall be modified by deleting from it that public right of way.
2. There shall, at the end of 28 days from the date of confirmation of this Order, be a public bridleway over the land situate at High Offley described in part 2 of the Schedule and shown by a bold broken line on the map contained in this Order and thereupon the Definitive Map for the Borough of Stafford shall be modified by adding the path to it.
3. The Definitive Statement for the Borough of Stafford shall be modified as described in part 4 of the Schedule to this Order.
4. The rights conferred on the public under this Order shall be subject to the Limitations and Conditions set out in Part 3 of the Schedule.

SCHEDULE

PART 1

DESCRIPTION OF SITE OF EXISTING PATH OR WAY

That length of Public Bridleway No.0.1517 High Offley Parish commencing from the junction with Public Bridleway No. 0.1522 High Offley Parish at point B on the Order plan (375785, 326067) and continuing in a generally northerly direction for approximately 82 metres passing the former Wharf Inn Public House to point A on the Order plan (375744, 326121).

PART 2

DESCRIPTION OF SITE OF NEW PATH OR WAY

A new length of Public Bridleway No.0.1517 High Offley Parish which commences at its junction with Bridleway No.01522 High Offley Parish at point C on the Order plan (375767, 326067) and continues in a generally northerly direction to point A on the Order plan (375744, 326121).

The new route of Public Bridleway No. 0.1517 High Offley Parish shall have a prescribed width of 3 metres between points C (375767, 326067) and A (375744, 326121) on the Order plan.

PART 3



LIMITATIONS AND CONDITIONS

The land owner is responsible for the upkeep and maintenance of the surface of the path in compliance with Staffordshire County Council Highways policies.

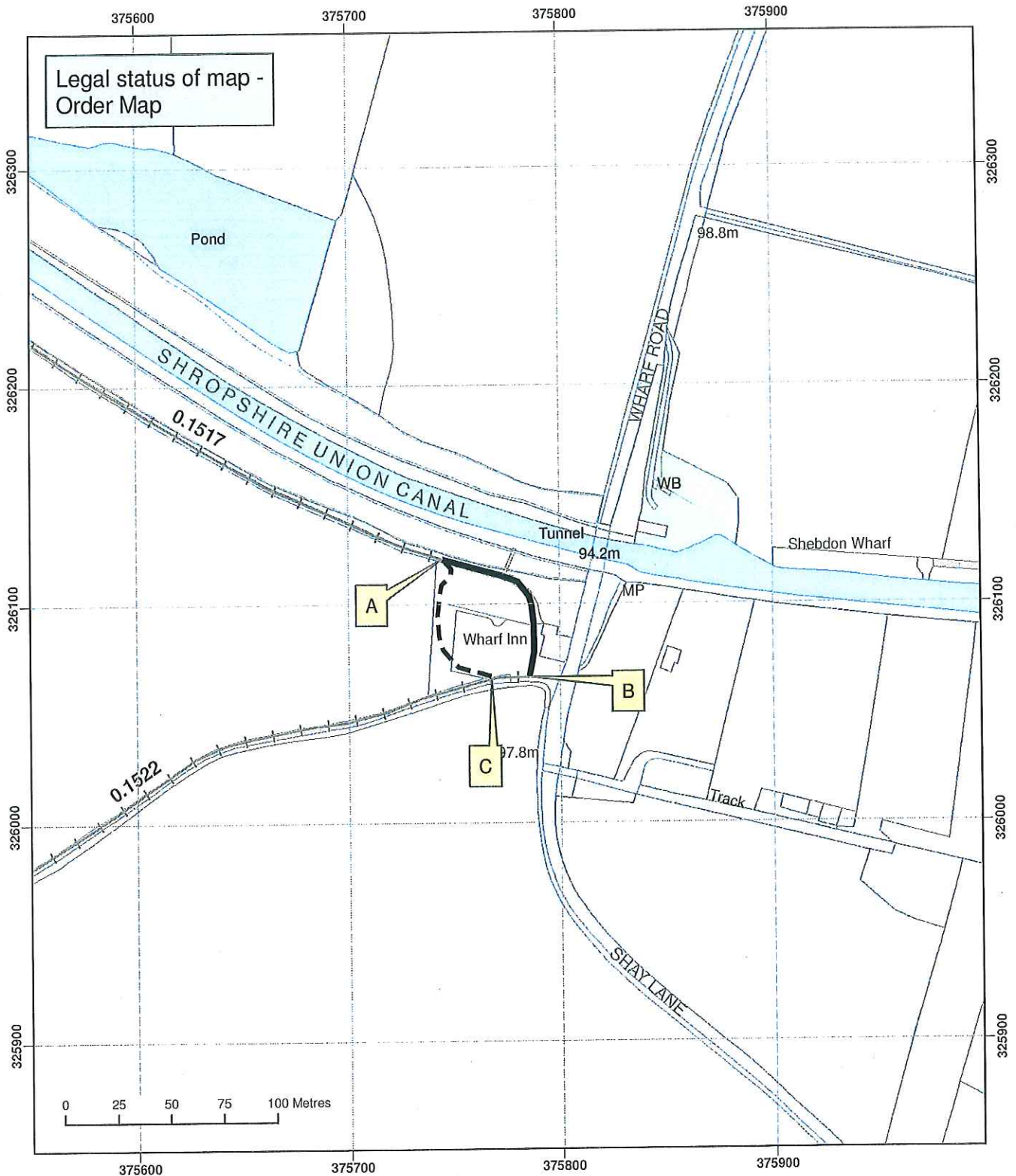
Highways Act 1980, Section 119 &
 Wildlife and Countryside Act 1981, Section 53A(2)
 Diversion of Bridleway No. 0.1517
 High Offley parish.



Map created at the scale of 1:2500
(facsimiles may vary)

-  Path to be extinguished (A - B).
-  Path to be created (A - C).

Rights of Way Unaffected

-  Bridleway



PART 4

MODIFICATION OF DEFINITIVE STATEMENT

VARIATION OF PARTICULARS OF PATH

County District: Stafford

Parish: High Offley

Path No	Type of Path	Path commences at	Path finishes at	Documents creating or modifying the right of way and other relevant information
0.1517	B.W	Path 25, S.E. of Batchacre Park Junction with B.W 25 S.E. of Batchacre Park Farm grid reference (375447, 326930).	County road at Wharf Lea, Shebden Junction with B.W. 0.1522, approximately 30 metres west of Shay Lane, Shebden grid reference (375767, 326067).	Staffordshire County Council Public Bridleway No.0.1517 (part) High Offley Parish. Public Path Diversion and Definitive Map and Statement Modification Order 2016.

Given under the Common Seal of Staffordshire County Council on 15 September 2016
Two thousand and Sixteen.

THE COMMON SEAL OF
STAFFORDSHIRE COUNTY COUNCIL
was hereunto affixed in the presence of:

161584

[Handwritten Signature]

Authorised Signatory

Confirmed as an unopposed Order on the 12 day of January Two thousand and SEVENTEEN



[Handwritten Signature]

Authorised Signatory

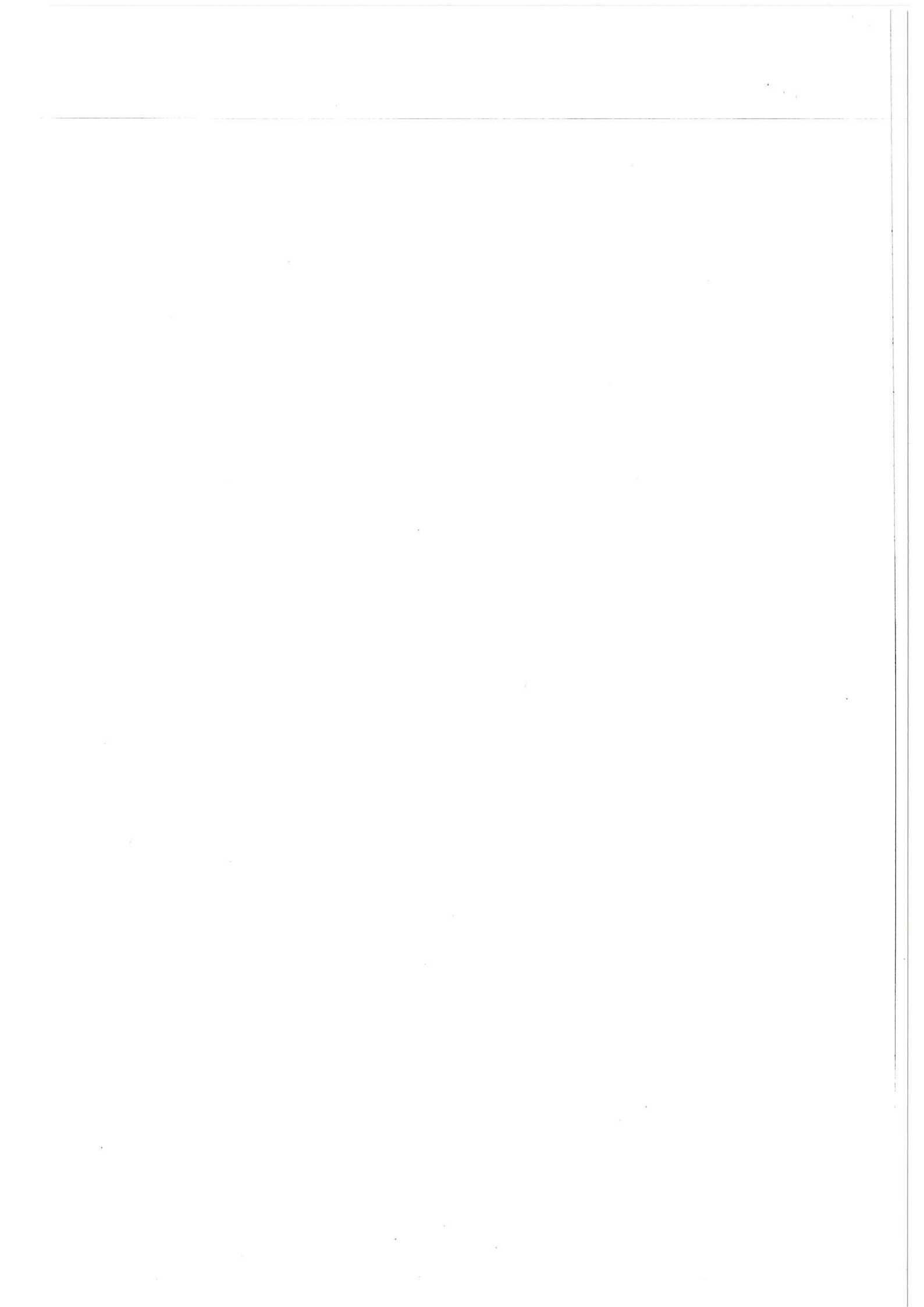

PUBLIC PATH DIVERSION AND DEFINITIVE MAP AND STATEMENT MODIFICATION ORDER

HIGHWAYS ACT 1980

WILDLIFE & COUNTRYSIDE ACT 1981

STAFFORDSHIRE COUNTY COUNCIL

**PUBLIC BRIDLEWAY NO.0.1517 (PART) HIGH OFFLEY PARISH
PUBLIC PATH DIVERSION AND DEFINITIVE MAP AND
STATEMENT MODIFICATION ORDER 2016**

This order is made by Staffordshire County Council ("the authority") under Section 119 of the Highways Act 1980 ("the 1980 Act") because it appears to the authority that in the interests of the owners of the land crossed by the bridleway as described in paragraph 1 of this Order, it is expedient that the line of the path should be diverted.

This Order is also made under Section 53A (2) of the Wildlife & Countryside Act 1981 (the 1981 Act") because it appears to the authority that the Definitive Map and Statement for the Borough of Stafford requires modification in consequence of the occurrence of an event specified in Section 53(3) (a) (i) of the 1981 Act, namely the diversion (as authorised by this Order) of highways shown or required to be shown in the Map and Statement.

The landowner has agreed to defray any expenses which are incurred in bringing the new site of the path into a fit condition for use by the public.

Stafford Borough Council has been consulted as to the making of the Order as required by Section 120(2) of the 1980 Act.

BY THIS ORDER

1. The public bridleway over the land situated at High Offley and shown by a bold continuous line on the map contained in this Order and described in part 1 of the Schedule to this Order shall be stopped up after 28 days from the date of confirmation of this Order, and thereupon the Definitive Map for the Borough of Stafford shall be modified by deleting from it that public right of way.
2. There shall, at the end of 28 days from the date of confirmation of this Order, be a public bridleway over the land situate at High Offley described in part 2 of the Schedule and shown by a bold broken line on the map contained in this Order and thereupon the Definitive Map for the Borough of Stafford shall be modified by adding the path to it.
3. The Definitive Statement for the Borough of Stafford shall be modified as described in part 4 of the Schedule to this Order.
4. The rights conferred on the public under this Order shall be subject to the Limitations and Conditions set out in Part 3 of the Schedule.

SCHEDULE

PART 1

DESCRIPTION OF SITE OF EXISTING PATH OR WAY

That length of Public Bridleway No.0.1517 High Offley Parish commencing from the junction with Public Bridleway No. 0.1522 High Offley Parish at point B on the Order plan (375785, 326067) and continuing in a generally northerly direction for approximately 82 metres passing the former Wharf Inn Public House to point A on the Order plan (375744, 326121).

PART 2

DESCRIPTION OF SITE OF NEW PATH OR WAY

A new length of Public Bridleway No.0.1517 High Offley Parish which commences at its junction with Bridleway No.01522 High Offley Parish at point C on the Order plan (375767, 326067) and continues in a generally northerly direction to point A on the Order plan (375744, 326121).

The new route of Public Bridleway No. 0.1517 High Offley Parish shall have a prescribed width of 3 metres between points C (375767, 326067) and A (375744, 326121) on the Order plan.

PART 3

LIMITATIONS AND CONDITIONS

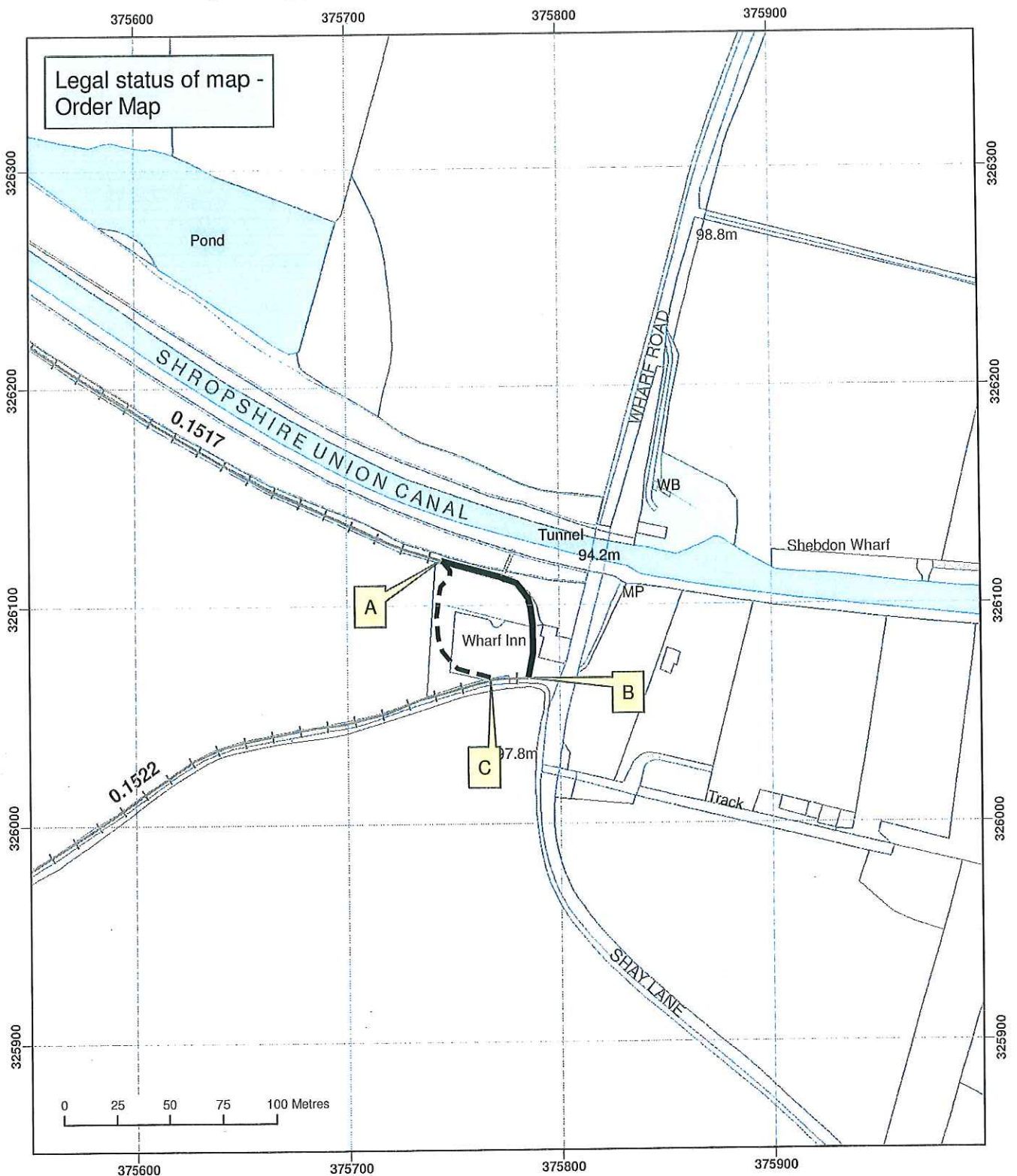

The land owner is responsible for the upkeep and maintenance of the surface of the path in compliance with Staffordshire County Council Highways policies.

Highways Act 1980, Section 119 &
 Wildlife and Countryside Act 1981, Section 53A(2)
 Diversion of Bridleway No. 0.1517
 High Offley parish.



Legal status of map -
Order Map

Map created at the scale of 1:2500
(facsimiles may vary)

-  Path to be extinguished (A - B).
-  Path to be created (A - C).

Rights of Way Unaffected
 Bridleway

© Crown Copyright and database rights 2016.
 Ordnance Survey 100019422. You are not permitted to copy, sub-license, distribute or sell any of this data to third parties in any form. Use of this data is subject to the terms and conditions shown at www.staffordshire.gov.uk/maps.
 Produced by Staffordshire County Council, 29/06/2016.



PART 4
MODIFICATION OF DEFINITIVE STATEMENT
VARIATION OF PARTICULARS OF PATH

County District: Stafford

Parish: High Offley

Path No	Type of Path	Path commences at	Path finishes at	Documents creating or modifying the right of way and other relevant information
0.1517	B.W	Path 25, S.E. of Batchacre Park Junction with B.W 25 S.E. of Batchacre Park Farm grid reference (375447, 326930).	County road at Wharf Lea, Shebdon Junction with B.W. 0.1522, approximately 30 metres west of Shay Lane, Shebdon grid reference (375767, 326067).	Staffordshire County Council Public Bridleway No.0.1517 (part) High Offley Parish. Public Path Diversion and Definitive Map and Statement Modification Order 2016.

Given under the Common Seal of Staffordshire County Council on 15 September 2016
 Two thousand and Sixteen.

**THE COMMON SEAL OF
 STAFFORDSHIRE COUNTY COUNCIL**
 was hereunto affixed in the presence of:

161584

P. Agnew

.....
 Authorised Signatory

Confirmed as an unopposed Order on
 the 12 day of JANUARY Two thousand
 and SEVENTEEN

P. Agnew

.....
 Authorised Signatory



