

CYCLE TRACK ORDER
CYCLE TRACKS ACT 1984
STAFFORDSHIRE COUNTY COUNCIL
CYCLE TRACK (NO. 18 SILVERDALE PARISH)
CYCLE TRACK ORDER 2015

The Order is made by Staffordshire County Council ("the authority") under Section 3 of the Cycle Tracks Act 1984 ("the 1984 Act") because it appears to the authority that it is in the interest of the public, that the footpath described in paragraph 1 of this order should be re-classified as a Cycle Track.

The developer Ibstocks Group Limited has agreed to defray any expenses which are incurred in bringing the site of the Cycle Track into a fit condition for use by the public.

Newcastle-under-Lyme Borough Council has been consulted to the making of the Order.

BY THIS ORDER

1. The public rights of way over the land situate at Silverdale in the Borough of Newcastle-under-Lyme and shown by bold green lines on the map contained in this Order and described in Part 1 of the Schedule to this Order shall be re-classified after 28 days from the date of confirmation of this Order.
2. There shall at the end of 28 days of the confirmation of this Order, be a Cycle Track over the land situate at Silverdale Parish in the Borough of Newcastle-under-Lyme as described in Part 2 of the Schedule to this Order and shown by bold green lines on the map contained in this Order.
3. The rights conferred on the public under this Order shall be subject to the Limitations and Conditions set out in Part 3 of the Schedule to this Order.
4. The Cycle Track shown by bold green lines on the map contained in this Order and described in Part 2 of the Schedule to this Order shall be recorded in the list of Publically Maintainable Highways kept by the authority under Section 36 of the Highways Act 1980.

SCHEDULE

PART 1

DESCRIPTION OF SITE OF EXISTING PATH

Parish – Silverdale

NGR - SJ822466

Commencement – 382276-346667

Terminus – 382290-346684

Width – from D - E 4.5 metres

from E – C 3 metres

A Public Footpath commencing (point A on the attached plan) on the north side of Church Street, Silverdale, approximately 22 metres east of the junction of Crown Street and Church Street and running in a generally northerly direction for approximately 23m. then in a generally north-easterly direction for approximately 17m. then in a generally northerly direction for approximately 6m. to its terminus at the junction of public footpath nos.18 and 19 Silverdale Parish (point C on the attached plan).

PART 2

DESCRIPTION OF SITE OF CYCLE TRACK

Parish – Silverdale

NGR - SJ822466

Commencement – 382276-346667

Terminus – 382290-346684

Width – from A - B 4.5 metres

from B – C 3 metres

A Cycle Track commencing (point A on the attached plan) on the north side of Church Street, Silverdale, approximately 22 metres east of the junction of Crown Street and Church Street and running in a generally northerly direction for approximately 23m. then in a generally north-easterly direction for approximately 17m. to its terminus approximately 6m. south of the junction of public footpaths nos.18 and 19 Silverdale Parish (point C on the attached plan).

PART 3

LIMITATIONS AND CONDITIONS

A gate and A-Frame sited at point B (382276 346665) and a gate and A-Frame sited at point C (382290 346683) on the Order plan. The surface of the new Cycle Track is tarmacadam and is publically maintainable.

No other works are required to bring this route into a fit condition for public use.

Given under the Common Seal of Staffordshire County Council on
17th December Two Thousand and Fifteen

**THE COMMON SEAL OF
STAFFORDSHIRE COUNTY COUNCIL**

was hereunto affixed in the presence of:



15/1004

15/1004



Authorised Signatory

Confirmed as an unopposed Order on
the... 4 ... day of... February ... Two
thousand and... 16 ...



Authorised Signatory

Cycletrack Act 1984, Section 3.

Creation of Public Cycletrack at Church Street, Silverdale.

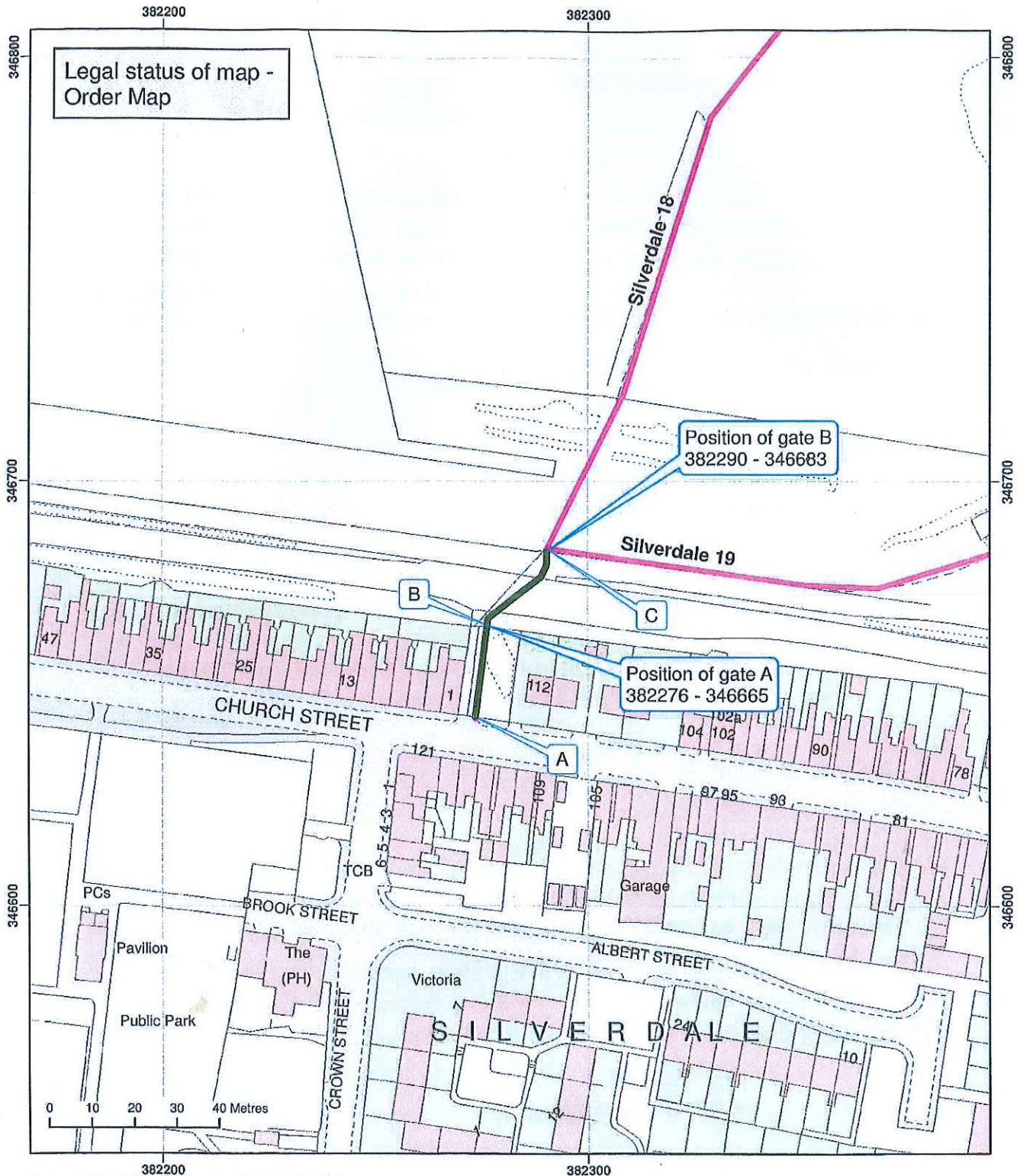

Map created at the scale of 1:1250 (facsimiles may vary)

Cycletrack to be created (A - B - C).

Rights of Way Unaffected

Footpath

© Crown Copyright and database rights 2015. Ordnance Survey 100019422. You are not permitted to copy, sub-license, distribute or sell any of this data to third parties in any form. Use of this data is subject to the terms and conditions shown at www.staffordshire.gov.uk/maps. Produced by Staffordshire County Council, 23/07/2015.