

**PUBLIC PATH DIVERSION AND DEFINITIVE MAP AND STATEMENT MODIFICATION  
ORDER**

**HIGHWAYS ACT 1980**

**WILDLIFE & COUNTRYSIDE ACT 1981**

**STAFFORDSHIRE COUNTY COUNCIL**

**PUBLIC FOOTPATH NO.4 (PART) HAUGHTON PARISH  
PUBLIC PATH DIVERSION AND DEFINITIVE MAP AND  
STATEMENT MODIFICATION ORDER 2015**

This order is made by Staffordshire County Council ("the authority") under Section 119 of the Highways Act 1980 ("the 1980 Act") because it appears to the authority that in the interests of the owners of the land crossed by the footpath as described in paragraph 1 of this Order, it is expedient that the line of the paths should be diverted.

This Order is also made under Section 53A (2) of the Wildlife & Countryside Act 1981 ("the 1981 Act") because it appears to the authority that the Definitive Map and Statement for the Borough of Stafford require modification in consequence of the occurrence of an event specified in Section 53(3) (a) (i) of the 1981 Act, namely the diversion (as authorised by this Order) of highways shown or required to be shown in the Map and Statement.

The landowner has agreed to defray any expenses which are incurred in bringing the new site of the paths into a fit condition or use by the public.

Stafford Borough Council has been consulted as to the making of the Order as required by Section 120(2) of the 1980 Act.

**BY THIS ORDER**

1. The public rights of way over the land situate at Haughton and shown by a bold continuous lines on the map contained in this Order and described in part 1 of the Schedule to this Order shall be stopped up after 28 days from the date of confirmation of this Order, and thereupon the Definitive Map for the Borough of Stafford shall be modified by deleting from it those public rights of way.
2. There shall, at the end of 28 days from the date of confirmation of this Order, be a public footpath over the land situate at Haughton described in part 2 of the Schedule and shown by a bold broken line on the map contained in this Order and thereupon the Definitive Map for the Borough of Stafford shall be modified by adding the path to it.
3. The Definitive Statement for the Borough of Stafford shall be modified as described in part 4 of the Schedule to this Order.
4. The rights conferred on the public under this Order shall be subject to the Limitations and conditions set out in Part 3 of the Schedule.



## **SCHEDULE**

### **PART 1**

#### **DESCRIPTION OF SITE OF EXISTING PATH OR WAY**

That length of Public Footpath No.4 Haughton Parish commencing from a point approximately 180 metres west north-west of Alstone Lane at point A on the order plan (386825 319521) and continuing in a generally west north-westerly direction for approximately 115 metres past Hanging Pits Farm to point B on the order plan (386714 319552) and continuing in a generally north north-westerly direction for approximately 203 metres to point C on the order plan (386610 319726) and continuing in a generally northerly direction for approximately 23 metres to its junction with Public Footpath No. 3 Haughton Parish at point D on the order plan (386611 319750).

### **PART 2**

#### **DESCRIPTION OF SITE OF NEW PATH OR WAY**

A new length of Public Footpath to form a continuation of Public Footpath known as No.4 Haughton Parish which commences at Alstone Lane, which, with that new length of footpath shall now be known as Public Footpath No.4(a) Haughton Parish. The new length of Public Footpath will commence from a point approximately 180 metres west north-west of Alstone Lane at point A on the order plan (386825 319521) and continuing in a generally north north-westerly direction for approximately 223 metres to point E on the order plan (386745 319728) and continuing in a generally westerly direction for approximately 18 metres to its junction with Public Footpath No.3 Haughton Parish at point F on the order plan (386728 319734).

The new route of Public Footpath No.4 Haughton Parish shall have a prescribed width of 1.8 metres between points A-E-F other than when passing through the kissing gates at point A on the order plan (386825 319521) and at point E on the order plan (386745 319728).

### **PART 3**

#### **LIMITATIONS AND CONDITIONS**

Pedestrian kissing gates in accordance with BS5709: 2006 will be installed on the new route of Public Footpath No.4 Haughton Parish at point A (386825 319521) and point E (386745 319728) on the Order plan.



Highways Act 1980, Section 119 &  
Wildlife and Countryside Act 1981, Section 53A(2)

Diversion of Public Footpath  
No.4 Houghton Parish.

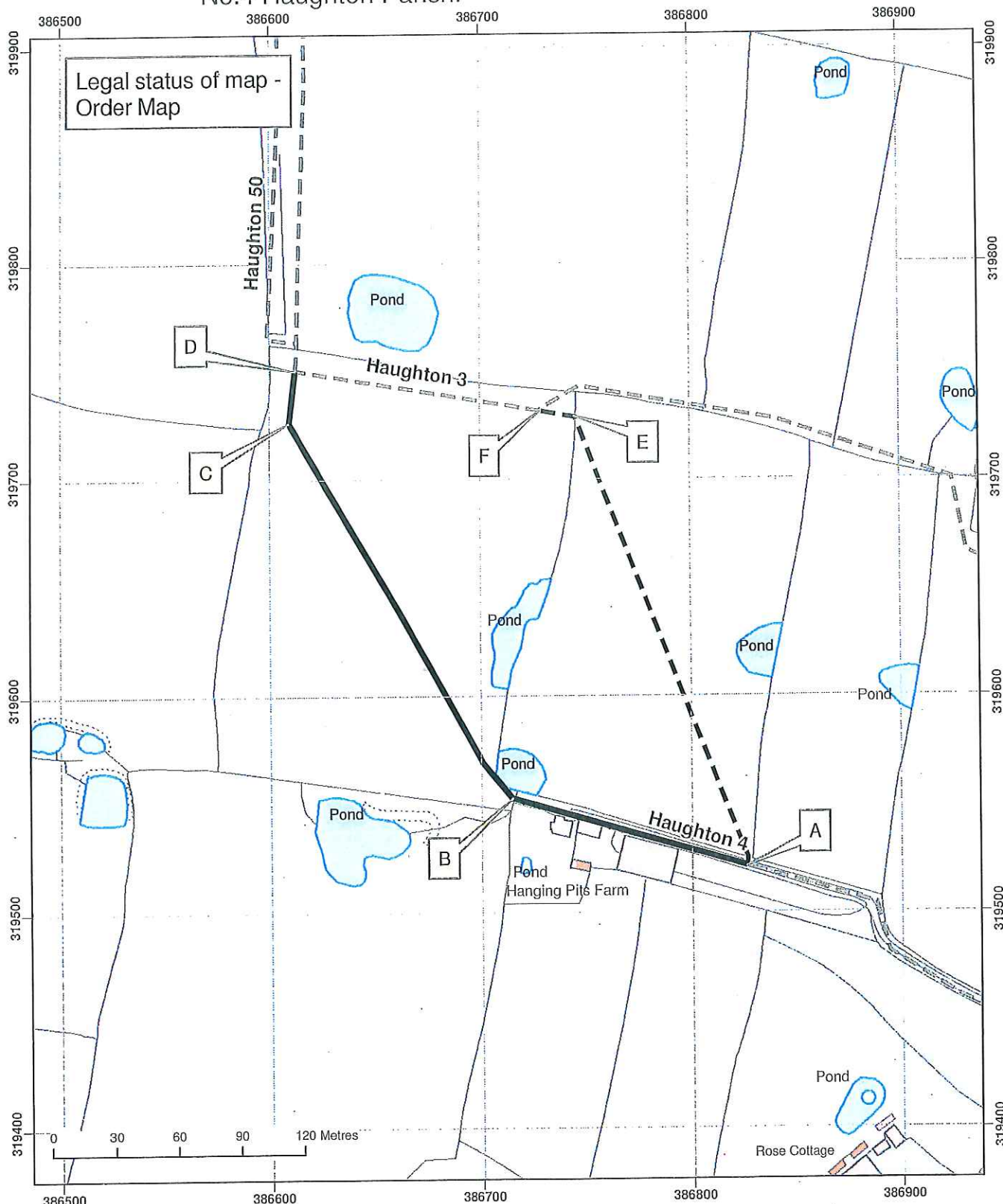

Map created at the scale of 1:2500  
(facsimiles may vary)

— Path to be extinguished (A - B - C - D).

- - - Path to be created (A - E - F).

Rights of Way Unaffected

== Footpath



# PART 4

## MODIFICATION OF DEFINITIVE STATEMENT

### VARIATION OF PARTICULARS OF PATH

County District: Stafford

Parish: Haughton

Path No	Type of Path	Path commences at	Path finishes at	Documents creating or modifying the right of way and other relevant information
4	F.P.	Alstone Lane by Folly Cottage. The western end of Public Footpath No.3 Haughton Parish at grid reference (386611 319750)	N.E. corner of Rosecroft Lane. Junction with Public Footpath No. 51 Haughton Parish south of Red Lion Farm.	Staffordshire County Council Public Footpath No.4 (part) Haughton Parish. Public Path Diversion and Definitive Map and Statement Modification Order 2015.
4(a)	F.P.	Adjacent to Alstone House, Alstone Lane.	Public Footpath No.3 Haughton Parish at grid reference (386728 319734).	Staffordshire County Council Public Footpath No.4 (part) Haughton Parish. Public Path Diversion and Definitive Map and Statement Modification Order 2015.

Given under the Common Seal of Staffordshire County Council on 15th day of December Two thousand and fifteen.

**THE COMMON SEAL OF  
STAFFORDSHIRE COUNTY COUNCIL**  
was hereunto affixed in the presence of:



Authorised Signatory

Confirmed as an unopposed Order on  
the 8th day of December Two thousand  
and SIXTEEN

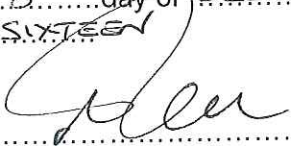

Authorised Signatory

