

A1

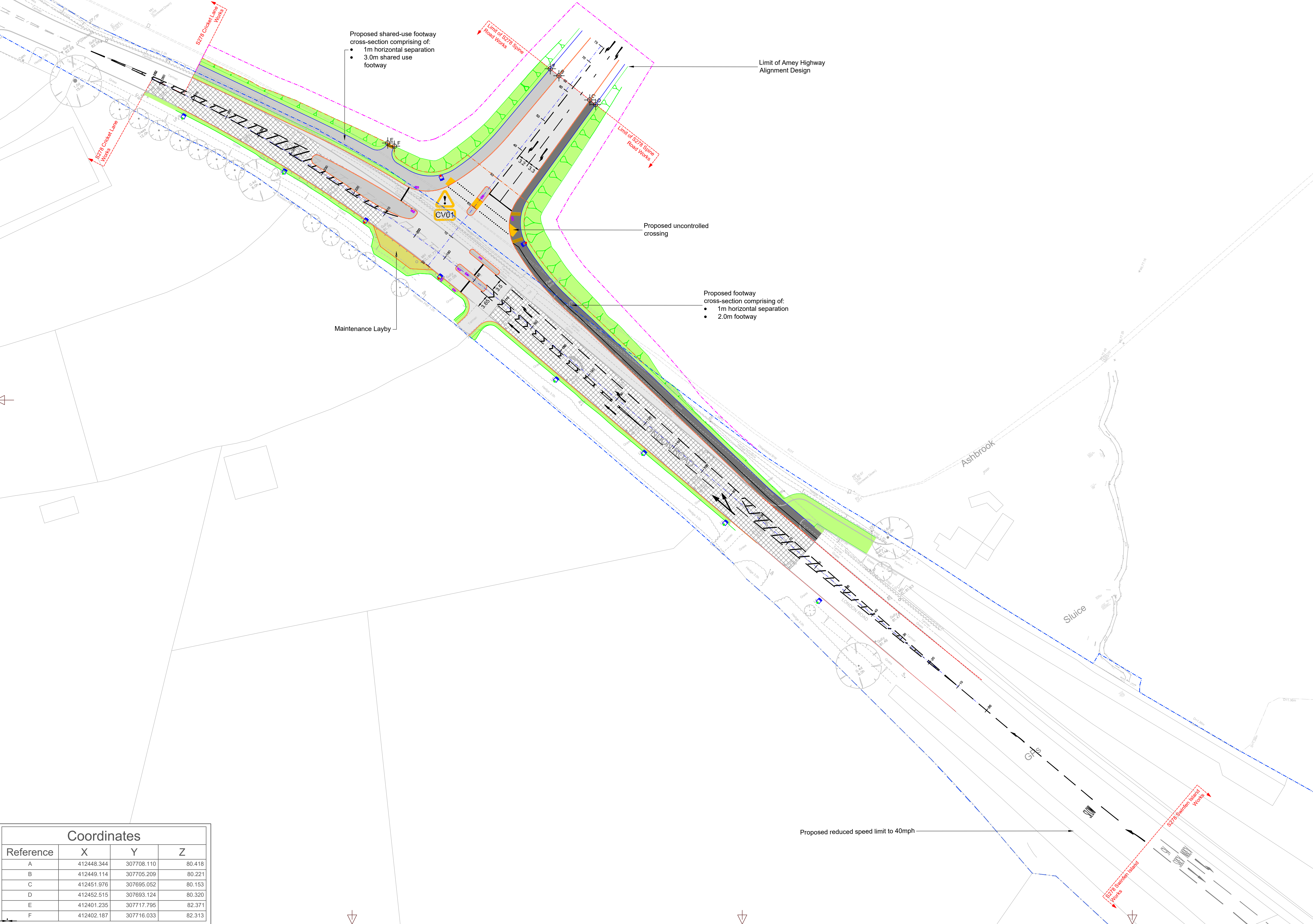

RESIDUAL DESIGN HAZARDS

(The following information has been collected from Preconstruction Information and the Amey CDM Hazard Management Process.)

1 STATs - Entire scheme area, refer to D0266G-R27 and STATs diversion plans

Key:

Existing Highway Boundary

Proposed Highway Boundary

Section 278 Works Boundary

Proposed Carriageway Construction

Carriageway Resurfacing

Proposed Footway/Cycleway Construction

Proposed Footway

Proposed Verge

Proposed Tactile Paving

Proposed Hazard Warning Tactile Paving Flags

Paved Area

Proposed Road Markings

Proposed Traffic Signal Head Location

Proposed Street Lighting Location

Existing Street Lighting Location

Coordinate Point

- Notes:
1. Road Markings shown for information only. See drawing D0266G-R12-01 to 02 for exact details.

2. Do not scale this drawing.

3. This drawing is to be read in conjunction with all other relevant engineers, architects and specialist design drawings and details.

4. All dimensions are in metres unless noted otherwise. All levels are in metres unless noted otherwise.

5. Any discrepancies noted on site are to be reported to the engineer immediately.

6. All Highway Works to be carried out in accordance with Staffordshire County Councils design guide and specifications.

7. The contractor shall check all tie-ins for line and level with existing before commencing any works. The engineer shall be notified immediately in writing, should any errors be found.

8. It is the responsibility of the contractor to locate any service apparatus in the vicinity of the works. The client will accept no claims whatsoever in respect of any losses or damage caused in respect of such apparatus, however caused. It is the responsibility of the contractor to execute the works at all times in strict accordance with the requirements of the Health and Safety at Work Act 1974, and the CDM regulations 2015. The contractor will be deemed to have allowed for full compliance, including full liaison within his rates.

9. The contractor will be responsible for providing all necessary de-watering and trench support to execute the works in a satisfactory manner, and shall be deemed to have allowed for the same within his rates.

10. Existing ironwork and covers to be adjusted to match new levels.

11. Contractor to ensure all existing drainage within the works is cleaned and jettied.

12. Prior to commencement of the S278 works, a joint survey is required of the public highway, adjacent to the proposed works and submitted to the LPA.

13. Upon completion of the S278 works, a joint survey of the public highway along with a schedule of dilapidations is to be submitted and agreed with the LPA.

C0	Original Drawing	RS	04/07/2025
Rev	Detail	By	Date

Revisions		
Design Model: REV 0		
Original Version	Preliminary	
	For target cost	
Drawn: RS	For tender	
Design: TC	For construction	✓
	As constructed	
Date: July 2025	Other	

Checked by:-

Approved by:- (Drawing NOT approved if this box is empty)

Staffordshire
County Council

working with

Amey

www.staffordshire.gov.uk

www.amey.co.uk

Project Name	
DCA London Road (New Access)	
Drawing Title	
General Arrangement (Sheet 1 of 1)	
Grid reference : 412402 307682	
Original Drawing Size : A1 Dimensions : m	
Scale : 1:500 Copyright © Amey	
Drawing No	Rev
D0266G-R01-01	C0

Coordinates			
Reference	X	Y	Z
A	412448.344	307708.110	80.418
B	412449.114	307705.209	80.221
C	412451.976	307695.052	80.153
D	412452.515	307693.124	80.320
E	412401.235	307717.795	82.371
F	412402.187	307716.033	82.313

Trim to this line for A1