

**Borough Road Active Travel Improvement Scheme,
Burton-upon-Trent
The Construction Phase**

Frequently Asked Questions:

Who is doing the works?

Amey Highways – Staffordshire County Council Infrastructure+ Contractor

Other works co-ordinated with the project including traffic signal upgrade will be carried out by SWARCO.

When are the works taking place?

Works is scheduled to start on 5 January 2026

What is the duration of the works?

Approximately 18 weeks

The works will be suspended for two weeks from 17/02/26 to allow for other essential works in Burton with traffic management removed except the Curzon Street road closure.

What are the working hours?

Typically, Monday – Friday 07:30 - 16:30 with Saturday working when required. It is not anticipated that there will be any Sunday working at this time

The works will be programmed to minimise disruption to residents, businesses pedestrians and traffic

What is the proposed phasing of the works?

The works will be carried out in phases as detailed on the traffic management drawings. The works will be programmed to minimise disruption to residents, businesses, pedestrians and traffic.

Works phasing will be updated as scheme is progressed

What Traffic Management will be in place?

Traffic Management strategy requires five distinct TM set-ups or operational phases. (Including the set up for Byrkley Street Signal Upgrade Scheme)

Temporary traffic lights with pedestrian crossings will replace the current traffic signals at Byrkley Street, Derby Street, Borough Road and Waterloo Street Gyratory while the roadworks take place, with footpath closures and diversions throughout the works.

Phase 1 (05/01/26 – 14/01/26)

A road closure from No. 19 Derby Street to the Borough Road junction and a lane closure on Borough Road from No. 38 Borough Road to the junction with Wellington Street.

Temporary parking restrictions will be in place on west side of Derby Street between No. 1 - 26. as detailed on Drawing No. D5327C/TM/SK01 below

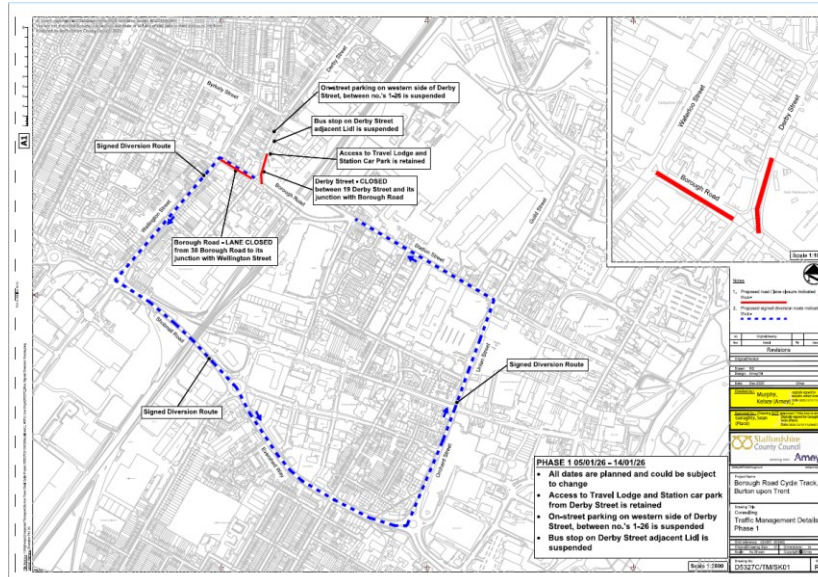

Diversion route will be via Borough Road, Wellington Street, Shobnall Road, Evershed Way, Orchard Street, Union Street and Station Street

Phase 2 (14/01/26 – 15/02/26)

A road closure on Borough Road from Station Court to the Curzon Street junction, leading into a lane closure on Borough Road to the junction with Wellington Street as detailed on Drawing No. D5327C/TM/SK02 below

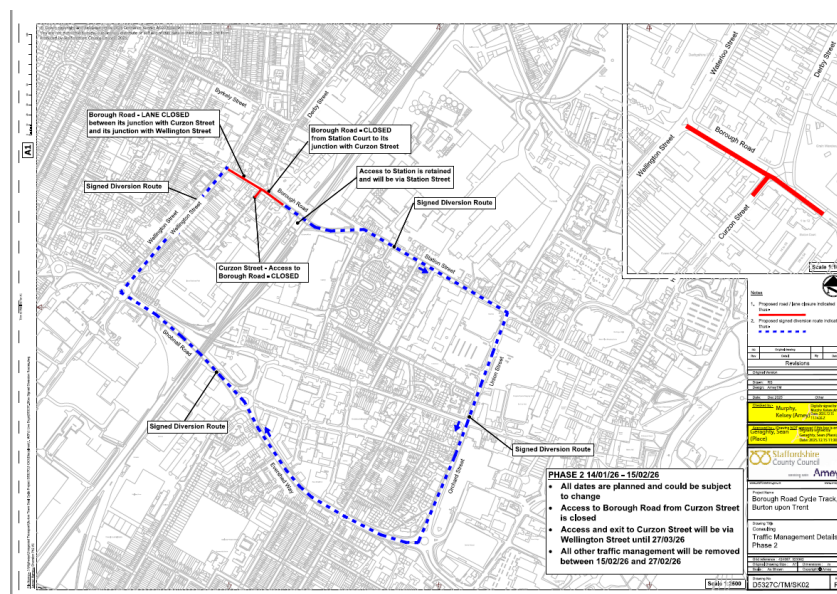

Diversion route will be via Station Street, Union Street, Orchard Street, Evershed Way, Shobnall Road and Wellington Street.

Access and exit to Curzon Street will be via Wellington Street and remain in place until 27/03/26.

The works will be suspended for two weeks from 17/02/26 to allow for other essential works in Burton with traffic management removed except the Curzon Street road closure.

Phase 3 (02/03/26 – 16/03/26)

A road closure from the Splitter Island of Shobnall Road roundabout northbound to Curzon Street. Whereby there will be 'access only' for frontages within the closure points

A full road closure will be in place between Curzon Street and No. 6 Waterloo Street, along with a road closure on King Edwards Place from Rangemore Street to Wellington Street as detailed on drawing No. D5327C/TM/SK03 below

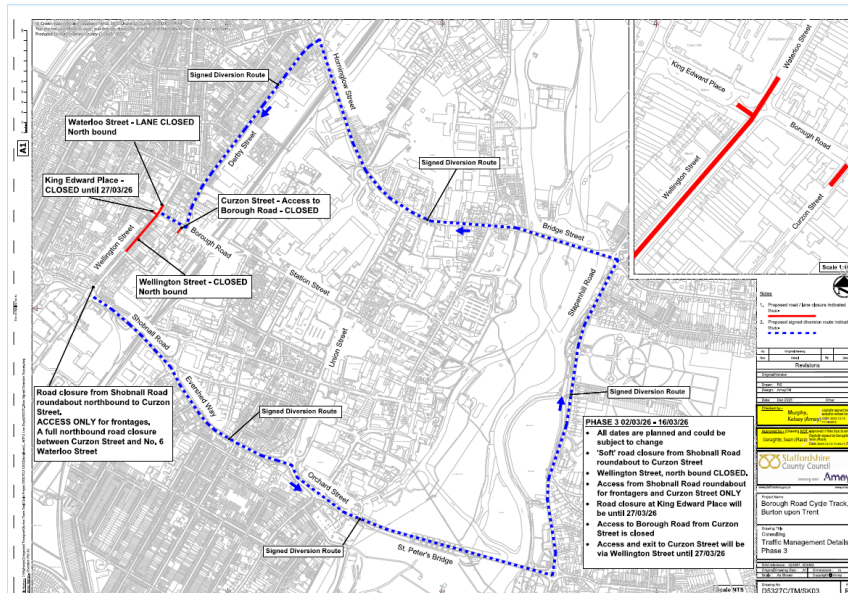

Traffic on Wellington Street will travel southbound in a one-way direction from Borough Road towards Curzon Street whereby it will become two-way traffic

Traffic from Borough Road will be able to turn left onto Waterloo Street

Diversion route will be via Shobnall Road, Evershed Way, Orchard Street, St Peters Bridge, Stapenhill Road, Bridge Street, Horninglow Street, Derby Street and Borough Road.

Phase 4 (16/03/26 – 15/04/26)

A road closure on Borough Road between No.37 and the Wellington Street junction, as well as a right-hand lane closure on Derby Street from No. 10 to the Borough Road junction.

The Southbound side of carriageway between No. 17 Wellington Street and Borough Road will also be closed as detailed on Drawing No. D5327C/TM/SK04 below

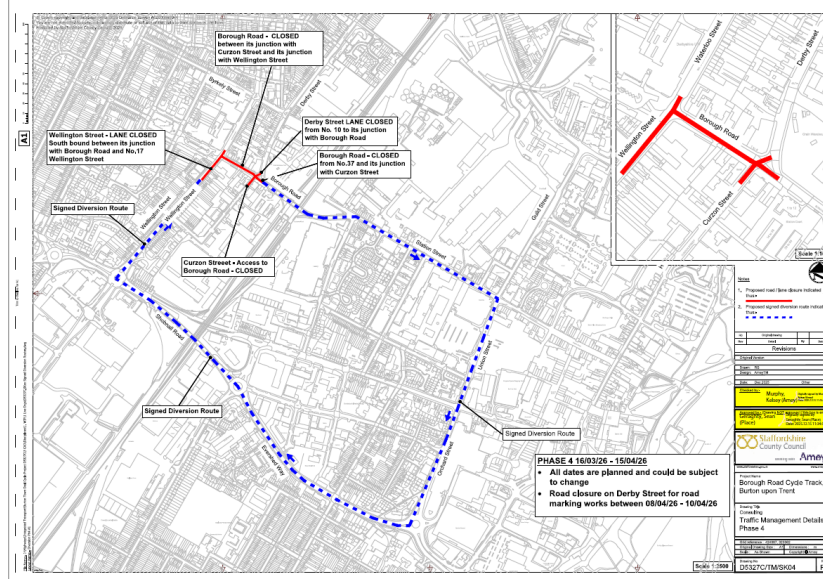

Diversion route will be via Station Street, Union Street, Orchard Street, Evershed Way, Shobnall Road and Wellington Street.

Phase 4a – Site extends Derby Street between Byrkley Street and Borough Road 08/04/25 – 10/04/25

Road closure on Derby Street between Albert Street and Borough Road for Installation of road markings and studs

Phase 5 (16/04/26 – 07/05/26)

A road closure on Byrkley Street at junction with Derby Street and Waterloo Street. Further details will be provided closer to the time.

- Curzon Street closed between 14/01/26 - 27/03/26
- King Edwards Place closed between 02/03/26 – 27/03/26

Diversion routes will be signed but please feel free to use other routes that might be more convenient to you.

Please note that the above dates are subject to change. Any changes will be communicated to you with further correspondence.

What access will there be along Borough Road / Derby Street / Wellington Street and Waterloo Street?

All roads will remain open to traffic where possible. Road and lane closures are required for certain aspects of the works. Details of traffic management proposals have been shown above.

Will I be able to access my home/business?

Yes, access will always be maintained for homes and businesses, except within the road closure, where works are taking place

Will there be access to the Railway Station?

Access to Railway Station drop off area directly outside the Station will be maintained throughout the duration of the works. When access is restricted from Derby Street, you will be required to follow signed diversion and access Borough

Road from Station Street. Details of traffic management proposals have been shown above.

Access to Railway Station Car Park?

Access to Railway Station Car Park Area will be maintained throughout the duration of the works. Should road closures be required west of the station then access will remain possibly from Station Street. Details of traffic management proposals have been shown above.

Is there any other works or collaborative working planned at the same time?

During this time, the county council will additionally take the opportunity to improve:

- The bus stop outside No. 14 Wellington Road.
- Traffic signals at junctions of Byrkley Street with Derby Street and Waterloo Street

Collaborative work

Other organizations own or operate equipment within the highway that needs to be repaired or upgraded. As part of this project, Staffordshire County Council will be working together with utility companies to seek other opportunities several organizations so that the work can be completed in a co-ordinated way, thereby reducing the number of times that there will be roadworks and reducing the total time for traffic management.

Will the works be noisy?

Although we will do our best to keep this to a minimum, please be aware that the works will generate noise throughout each working shift especially during the nighttime phases (if this is required).

What happens if my property is within the extents of full road closure?

Amey Highways site team will work with individuals affected by the works, but access may be restricted, and you may need to park outside of the works

What happens if my business is within the extents of full road closure?

Amey Highways site team will work with business's affected by the works, but access may be restricted.

What will happen to bus services affected by the works?

Amey Highways are working with affected bus operators and revised timetables / bus stops and routes will be issued once agreed with Staffordshire County Council Passenger Transport and bus operators

Who do I contact regarding any other points which have not been answered with the FAQ's ?

Further information can be via:

Website: www.staffordshire.gov.uk/Highways/roadworks/eaststaffs/Overview.aspx

Email: intraprojects@staffordshire.gov.uk