





**KEY:**

-  Proposed double yellow lines. No waiting at any time.
-  Proposed single yellow lines. Waiting prohibited between Monday to Friday 08:00-09:30am and 2:30-4:00pm. Signs and posts to be placed on footway.
-  No stopping at any time except buses
-  School Keep Clear No stopping Monday - Friday 8am-5pm

File Name: J:\Highways\Integrated Transport\Land north of Burton Road, Streethay Roman Heights RDS0116-R01-01 RevA.dwg  
 Layout Name: RDS0116-R01-01  
 A3

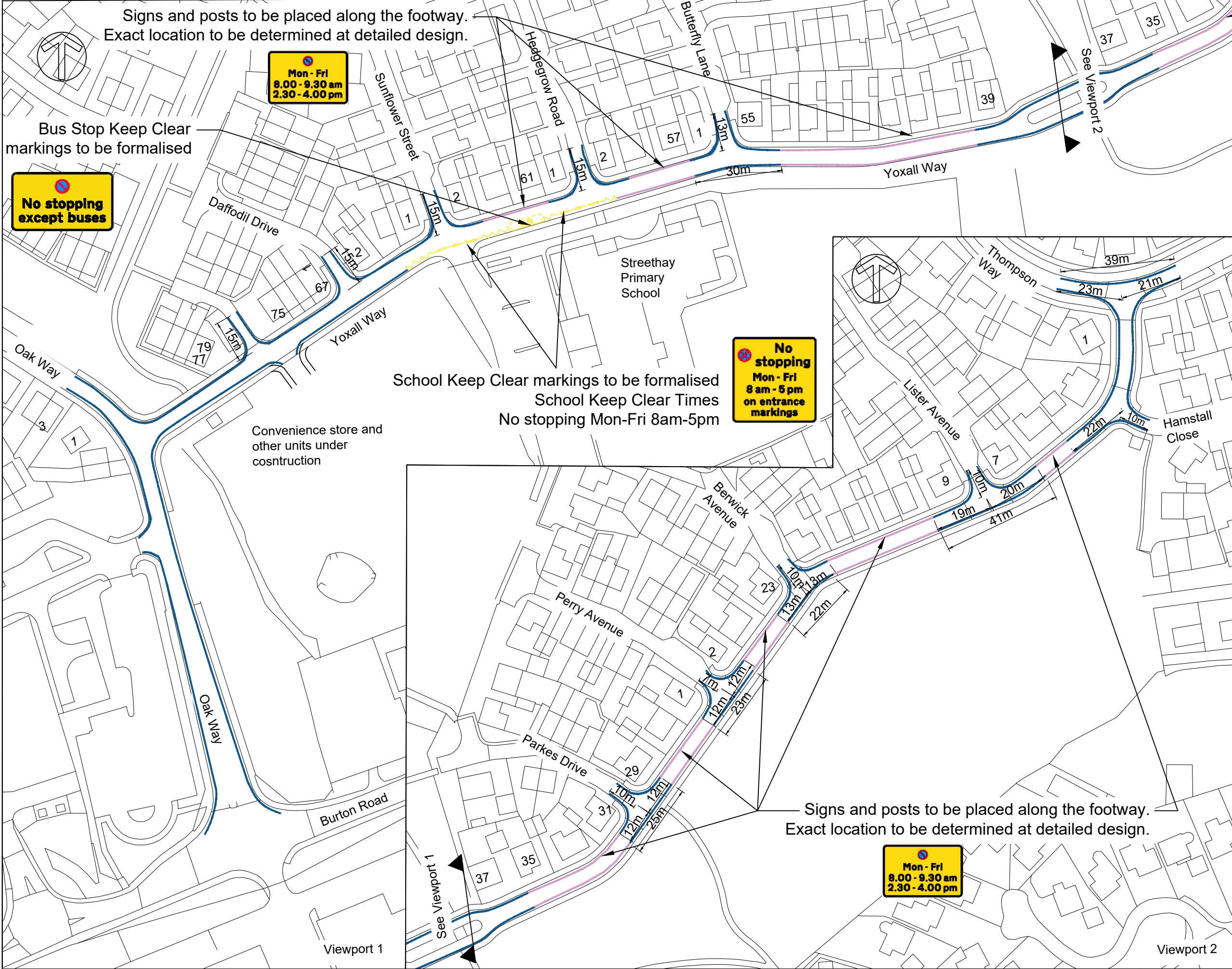

P1	Extended TRO to Thompson Way	GT	25.04.2023
P0	First Issue	GT	23.08.2022
Rev	Detail	By	Date

Revisions	
Original Version	Preliminary
Drawn: GT	For comment <input checked="" type="checkbox"/>
Design: GT	For tender
	For construction
	As constructed
Date: August 2022	Other

Checked by:-

Approved by:- (Drawing NOT approved if this box is empty)



Project Name  
 Land North of Burton Road,  
 Roman Heights,  
 Streethay, Lichfield

Drawing Title  
 Amey Consulting  
 Consultation Plan

Grid reference : 413221, 324975	
Original Drawing Size : A3 Dimensions : m	
Scale : 1:1250 Copyright © Amey	
Drawing No RDS0116-R01-01	Rev P1