

Scheme Update – July 2021

Scheme Progress

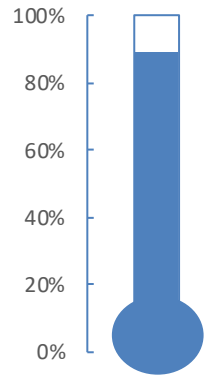

Visit our website to see the latest video drone footage of the scheme

Introduction

We continue to make great progress with works to the viaduct continuing between Madford Retail Park and Doxey Road Car parks with the first layer surfacing planned for August. Doxey Road railway bridge is fully open, works are ongoing to the footways running along the railway line on Doxey Road as you approach the bridge, with surfacing planned for August.

Landscaping and maintenance works are ongoing in readiness for scheme completion. Accommodation works will commence at Madford RP and Doxey Road car parks which will include drainage, kerbing, surfacing, white lining and flood lighting.



What's coming up

The Kingsway and Martin Drive closure is planned to carry out resurfacing works to the existing carriageway near the new toucan crossings. The closure will take place week commencing 2nd August and be in place for 5 days subject to any unforeseen circumstances.

Due to the nature of these works disruption to traffic is likely, however, we will work hard to ensure delays are kept to a minimum and access is maintained to properties and businesses throughout. Pedestrian and cycle access will be maintained throughout; however, we do ask that you take extra care when passing through this section of works.

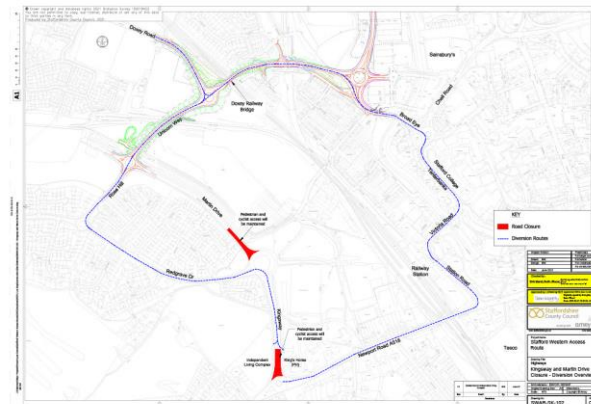

Full size diversion drawing available on our website. Dwg No: SWAR/SK/102

Key Milestones

Continue viaduct works between Madford and Doxey Road Car Parks



July

First layer surfacing works to the viaduct



August

Final surfacing works to viaduct

Accommodation works to Doxey Road and Madford Retail Park car parks



September

Scheme Complete



October

*Dates in accordance with current programme and could be subject to change