

KEY

- Carriageway
- Footway & paved areas
- Grass Verge
- Doxey and Tillington Marshes Site of Special Scientific Interest (SSSI)
- Area of existing car park to be developed into wildlife habitat
- Area of destroyed SSSI to be returned
- Extent of viaduct structure

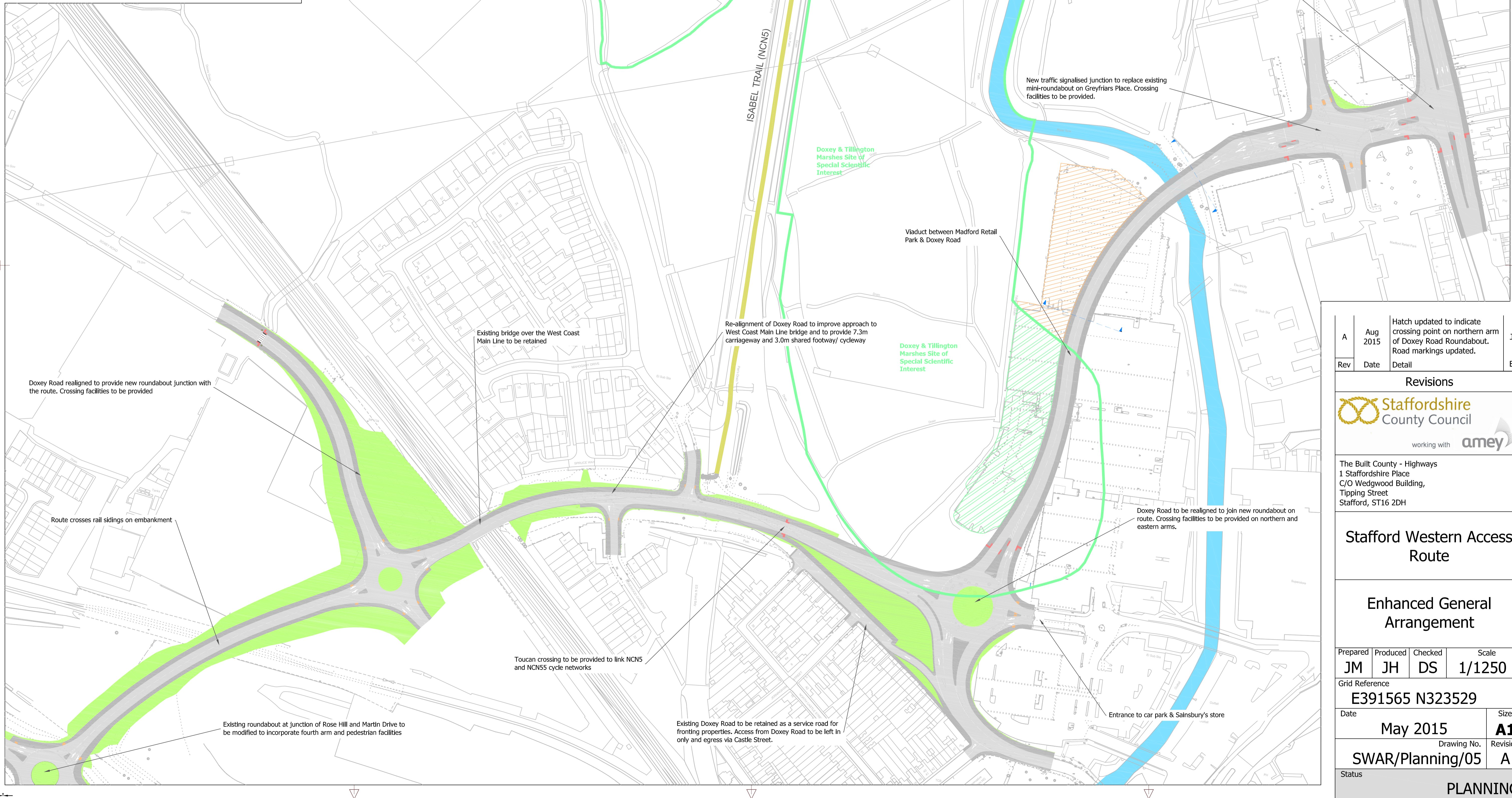

A	Aug 2015	Hatch updated to indicate crossing point on northern arm of Doxey Road Roundabout. Road markings updated.	JH
Rev	Date	Detail	By

Revisions

working with

The Built County - Highways
1 Staffordshire Place
C/O Wedgwood Building,
Tipping Street
Stafford, ST16 2DH

Stafford Western Access Route

Enhanced General Arrangement

Prepared	Produced	Checked	Scale
JM	JH	DS	1/1250
Grid Reference			
E391565 N323529			
Date	May 2015	Size	A1
Drawing No.		Revision	
SWAR/Planning/05		A	
Status			
PLANNING			

File Name: J:\Highways\Major Projects\Stafford Western Access Route\CAD\Disciplines\WIP\3 Temp\002_Planning\SWAR_Planning_05A - Enhanced_General_Arrangement.dwg
Layout Name: A1
Title to this line for A1