

Part A: Information relating to the applicant and land to which the application relates

(All applicants must complete this part)

1. Name of appropriate authority to which the application is addressed

Staffordshire County Council

2. Name and full address (including postcode) of applicant

DENISE KENDALL, LITTLE HILLEND, QUARNFORD, BUXTON
SK17 0SZ

3. Status of applicant (tick relevant box or boxes):

- I am (a) ☒ the owner of the property/land(s) described in paragraph 4
(b) ☐ making this application and the statements/declarations it contains on behalf of

who is the owner of the property/land(s) described in paragraph 4 and in my capacity as

4. Insert description of the property/land(s) to which the application relates including full address and postcode

Little Hillend is a dwelling converted from farm house by 1976, in 2 acres of garden, with Public footpath Quarnford 17 running through it near to the main door.

5. Ordnance Survey six-figure grid reference(s) of a point within the area of land(s) to which the application relates (if known) e.g. SJ955 185 or SJ955185

SK 014 654

Owners:

If you have ticked box (a) and wish to deposit the Statement and Map **only** under Section 31(6) please fill in the rest of this section, then Parts B(i), E and F as appropriate. Note that the Declaration must be deposited within 20 years of the date the Statement and Map were received by Staffordshire County Council.

If you have ticked box (a) and wish to deposit the Statement and Map **and** make the Declaration under Section 31(6), please fill in the rest of this section, then Parts B(i), C(i), E and F as appropriate.

If you have ticked box (a) and wish **only** to make the Declaration as you have previously deposited your Statement and Map, please fill in the rest of this section, then Parts C(i), E and F as appropriate.

If you have ticked box (a) and wish to make a statement under Section 15A(1), please fill in the rest of this section, then D(i), E and F as appropriate.

Authorised Representative:

If you have ticked box (b), and wish to deposit the Statement and Map **only** under Section 31(6), please fill in the rest of this section, then Parts B(ii), E and F as appropriate. Note that the Declaration must be deposited within 20 years of the date the Statement and Map were received by Staffordshire County Council.

If you have ticked box (b), and wish to deposit the Statement and Map **and** make the Declaration, please fill in the rest of this section, then Parts B(ii), C(ii), E and F as appropriate.

If you have ticked box (b) and wish **only** to make the Declaration as you have previously deposited your Statement and Map, please fill in the rest of this section, then Parts C(ii), E and F as appropriate.

If you have ticked box (b) and wish to make a Statement under Section 15A(1), please fill in the rest of this section, then D(ii), E and F as appropriate.

Part F must be completed in all instances

6. This deposit comprises the following statement(s) and/or declarations

- ☒ Part B
- ☐ Part C
- ☐ Part D

Part B(i): Statement under Section 31(6) of the Highways Act 1980
(Owner to complete)

1.1. DENISE KENDALL am the owner of the property/land described in paragraph 4 of Part A of this form and shown edged RED on the map accompanying this statement.

Ways shown none on that map are byways open to all traffic;

Ways shown none on that map are restricted byways

Ways shown none on that map are public bridleways;

Ways shown coloured YELLOW on that map are public footpaths;

Please type 'none' where no right of way of that type exists.

No (other) ways over the land shown edged RED on the accompanying map have been dedicated as highways.

Part E: Additional Information relevant to the application

My stepfather Peter Kendall and his first wife Hazel bought Little Hillend as a near-ruin in 1973, and by 1976 it had been converted to a modern dwelling. My mother was an old friend of Hazel.

1977 I first visited them at Little Hillend

1977-1994 My mother visited them every year or so, and I accompanied her on a couple of occasions during that period

1994-2006 Peter had been widowed, and married my mother, so I visited her and Peter at Little Hillend every 6 – 8 weeks

2006-2012 It became clear that they were needing help, and I moved here permanently as their carer.

2019-2012 Peter died, and my mother inherited the property. I continued to live here as her carer.

2019-present My mother died and I inherited the property, and I continue to live here.

So since 1977 I have had an increasing knowledge of Little Hillend, and in that time I have never seen, nor heard mentioned or referred to, any users of the public footpath on anything but their own two feet. There are plenty of recreational walkers, and organised groups such as Duke of Edinburgh participants, but I can find no trace in the various databases of any previous Landowner Statement in the surrounding neighbourhood, nor as yet any indication on older maps of the footpath through our garden and car park being anything but that, nor any indication on our pre-Land Registry deeds.

There are yellow Public Footpath arrows at the ends of our drive and garden. There is a 4-foot gate at the top of the garden, and a cattle grid across the bottom of the drive since 1994 – my stepfather had heart trouble, and this was to save him having to open and shut a gate. It was also installed to prevent ingress to the garden of sheep which periodically escape from the surrounding fields. There is a 2-foot gated access for walkers who do not wish to negotiate the cattle grid, although many do.

There has never been a need to redirect horse riders or cyclists away from the footpath.

As the footpath passes through the car park and close to the house, the unpredictability of horses when startled or around unfamiliar things is not an inviting prospect.

Quarnford footpath 31 is now subject to a modification order to upgrade it to bridleway. As “our” footpath Quarnford 17 is an apparent direct continuation to Quarnford 31 (but 17 is not a subject of that application to modify order), I am submitting this Landowner Statement and Map, and shortly a Declaration, to make it clear that I do not intend to dedicate any more public rights over my property than already exist for the footpath Quarnford 17, that is, right of way on foot only.

Part F: Statement of Truth

(All applicants must complete this part)

Warning: If you dishonestly enter information or make a statement that you know is, or might be, untrue or misleading, and intend by doing so to make a gain for yourself or another person, or to cause loss or the risk of loss to another person, you may commit the offence of fraud under Section 1 of the Fraud Act 2006, the maximum penalty for which is 10 years imprisonment or an unlimited fine, or both.

I believe that the facts and matters contained in this form are true

Signature of the person/s making the statement of truth
(An electronic signature is acceptable)

[Redacted signature box]

Print your full name:

DENISE KENDALL

Date:

26 January 2022

Please ensure you keep a copy of the completed form.

Please note: When you click the 'submit form' button below, it will open your email. Please also attach a scanned copy of your map with your form.

Submit form

Alternatively, please print off the completed form, sign and return with your map and payment to:

Landowner Statements and Declarations, Spatial Information Team,
Staffordshire County Council, Staffordshire Place 1,
Tipping Street, Stafford. ST16 2DH

HM Land Registry Current title plan

Title number **SF574422**
Ordnance Survey map reference **SK0165SW**
Scale **1:1250 enlarged from 1:2500**
Administrative area **Staffordshire :**
Staffordshire Moorlands

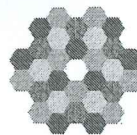

©Crown Copyright. Produced by HM Land Registry. Reproduction in whole or in part is prohibited without the prior written permission of Ordnance Survey. Licence Number 100026316

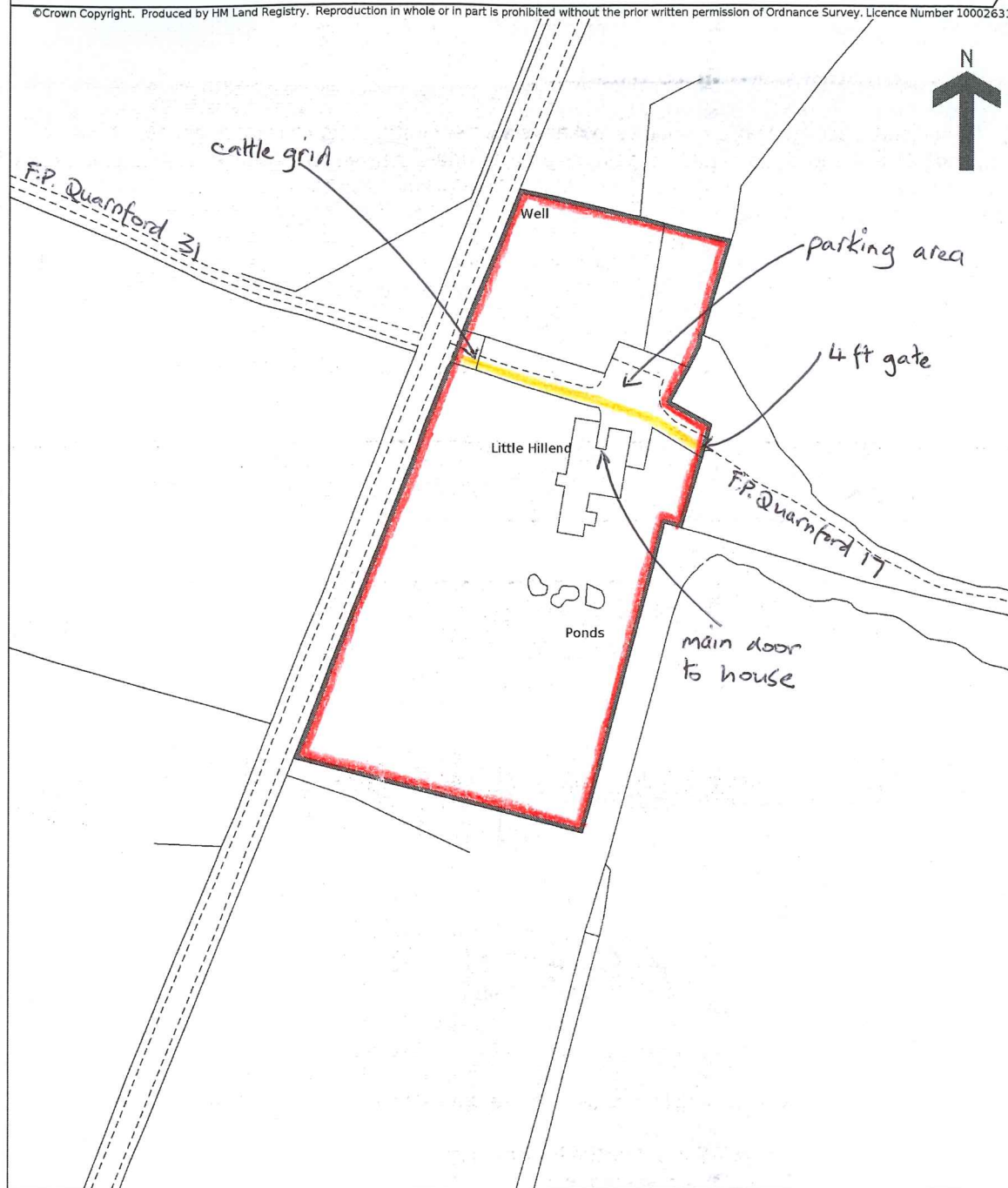

This is a copy of the title plan on 26 JUN 2020 at 15:32:12. This copy does not take account of any application made after that time even if still pending in HM Land Registry when this copy was issued.

This copy is not an 'Official Copy' of the title plan. An official copy of the title plan is admissible in evidence in a court to the same extent as the original. A person is entitled to be indemnified by the registrar if he or she suffers loss by reason of a mistake in an official copy. If you want to obtain an official copy, the HM Land Registry web site explains how to do this.

HM Land Registry endeavours to maintain high quality and scale accuracy of title plan images. The quality and accuracy of any print will depend on your printer, your computer and its print settings. This title plan shows the general position, not the exact line, of the boundaries. It may be subject to distortions in scale. Measurements scaled from this plan may not match measurements between the same points on the ground.

This title is dealt with by HM Land Registry, Birkenhead Office.