

**Public Path (Diversion) Order**  
**Town and Country Planning Act 1990, Section 257**  
**Wildlife and Countryside Act 1981, Section 53A**

**Staffordshire County Council**  
**Public Path Diversion Order 2015**  
**Public Footpath No. 4 and No. 5 Rocester Parish**

This Order is made by Staffordshire County Council under Section 257 of the Town and Country Planning Act 1990, because it is satisfied that it is necessary to divert the footpaths to which this order relates in order to enable development to be carried out in accordance with planning permission granted under Part III of the Town and Country Planning Act 1990 namely; to facilitate the New School development off Ashbourne Road, Rocester, Uttoxeter.

This Order is also made under Section 53A(2) of the Wildlife & Countryside Act 1981 ("the 1981 Act") because it appears to the authority that the Definitive Map and Statement for the District of East Staffordshire District require modification in consequence of the occurrence of an event specified in Section 53A(a)(i) of the 1981 Act, namely the diversion (as authorised by this Order) of a highway shown or required to be shown in the Map and Statement.

**BY THIS ORDER:**

1. The public rights of way over the land at Rocester in East Staffordshire District, shown by a bold continuous black line on the attached map and described in part 1 of the Schedule to this Order after 28 days from the date of confirmation of this Order, and thereupon the Definitive Map for the District of East Staffordshire shall be modified by deleting from it those public rights of way.
2. There shall, at the end of 28 days from the date of confirmation of this Order, be public footpaths over the land situate at Rocester in the District of East Staffordshire as provided in Part 2 of the Schedule and shown by bold black broken lines on the attached map and thereupon the Definitive Map for the District of East Staffordshire shall be modified by adding those paths to it.
3. The diversion of the footpaths shall have effect on the confirmation of this Order.
4. Where immediately before the date on which a footpath is diverted there is apparatus under, in, on, along or across it belonging to statutory undertakers for the purpose of carrying on their undertaking, the undertakers shall continue to have the same rights in respect of the apparatus as they then had.

## **Schedule**

### **Part One**

#### **Description Existing Paths**

##### **Footpath No 4 Rocester**

A Public Footpath known as Footpath No.4 Rocester Parish commencing (point A on the attached plan) on the south side of the B5030 road (Rocester to Ashbourne) approximately 345 meters North-east of its junction with the B5031 road (Rocester to Denstone road). Running due south for several metres then running in a generally south-westerly direction for approximately 170 metres then in a different but still generally south-westerly direction for approximately 240 metres to its terminus on the north side of the C001Q road (Ashbourne Road) approximately 45 metres south-east of its junction with the B5030 road (point B on the attached plan).

Commencement – 411040-340173 (point A)

Terminus – 410796-339836 (point B)

##### **Footpath No 5 Rocester**

A Public Footpath known as Footpath No.5 Rocester Parish commencing (point A on the attached plan) on the south side of the B5030 road (Rocester to Ashbourne) approximately 345 meters North-east of its junction with the B5031 road (Rocester to Denstone road). Running in a generally southerly direction for approximately 290 metres then in a different but still generally southerly direction for approximately 158 metres terminating approximately 32 metres north-west of the dwelling known as No.3 Woodseat Grove (point C on the attached plan).

Commencement – 411040-340173 (point A)

Terminus – 411078-339727 (point C)

### **Part Two**

#### **Description of New Paths**

##### **New Route of Footpath No 4 Rocester**

Commencing at (point D on the attached plan) the B5030 road approximately 320m North-east of its junction with the B5031 road and proceeding in a generally South-westerly direction for approximately 258m. then in a generally Southerly direction for approximately 20m. then in a generally South-westerly direction for approximately 165m. to terminate at Ashbourne Road, Rocester, approximately 10m from the junction with the B5030 road (point E on the attached Plan).

Commencement - 411057-340188 (point D on attached plan)

Terminus - 410786-339867 (point E on attached plan)

### **New Route of Footpath No 5 Rocester**

Commencing at (point D on attached plan) the B5030 road approximately 320m North-east of its junction with the B5031 road and proceeding in a generally South-south-easterly direction for approximately 185m. then in a generally South-westerly direction for approximately 15m. then proceeding in a generally Southerly direction for approximately 270m. terminating at a point on footpath no.5 approximately 63m. due North of Northfield Avenue, Rocester (point F on attached plan).

Commencement - 411057-340188 (point D on attached plan)

Terminus - 411078-339726 (point F on attached plan)

### **Part Three**

#### **Limitations and Conditions**

Medium mobility kissing gates in accordance with BS5709:2006 will be installed at points X (410867-339996) E (410786-339867) Y (411080-339928) and F (411078-339726) on the order plan.

The new routes shall have a prescribed width of at least 2 metres.

### **Part Four**

#### **Modification of Definitive Statement**

##### **Variation of Particulars of Path**

<b>Path No.</b>	<b>Type of Path</b>	<b>Path commences at</b>	<b>Path finishes at</b>	<b>Documents creating or modifying the right of way and other relevant information</b>
4	P.F	Ashbourne Road, 100 yds. from Whites Bridge, Rocester  Commencing at the B5030 road approximately 320m North-east of its junction with the B5031 road	Ashbourne Road, N.W. of Doveflats Farm  Terminates at Ashbourne Road, Rocester	Public Path (Diversion) Order Town and Country Planning Act 1990, Section 257 Wildlife and Countryside Act 1981, Section 53A  Staffordshire County Council Public Path Diversion Order 2015 Public Footpath No. 4 and No. 5 Rocester Parish

5	P.F	Wicket gate of Ashbourne branch of railway line, N.E. of Dove Lane  Commencing at the B5030 road approximately 320m North-east of its junction with the B5031 road	Ashbourne Road, N.W. of Doveflats  Terminating at a point on footpath no.5 approximately 63m. due North of Northfield Avenue, Rocester	Public Path (Diversion) Order Town and Country Planning Act 1990, Section 257 Wildlife and Countryside Act 1981, Section 53A  Staffordshire County Council Public Path Diversion Order 2015 Public Footpath No. 4 and No. 5 Rocester Parish
---	-----	--------------------------------------------------------------------------------------------------------------------------------------------------------------------------	----------------------------------------------------------------------------------------------------------------------------------------------	---------------------------------------------------------------------------------------------------------------------------------------------------------------------------------------------------------------------------------------------------

Given under the Common Seal of the Staffordshire County Council on the 20<sup>th</sup> day of October Two Thousand and Fifteen

THE COMMON SEAL OF THE STAFFORDSHIRE COUNTY COUNCIL was hereunto affixed in the presence of:-



[Signature]  
 Authorised Signatory

Confirmed as an unopposed Order on the 14<sup>th</sup> day of February, Two thousand and 16

[Signature]  
 Authorised Signatory

Town and Country Planning Act 1990, Section 257 &  
 Wildlife and Countryside Act 1981, Section 53A(2)  
 Diversion of Public Footpaths  
 Nos. 4 and 5 Rocester Parish.

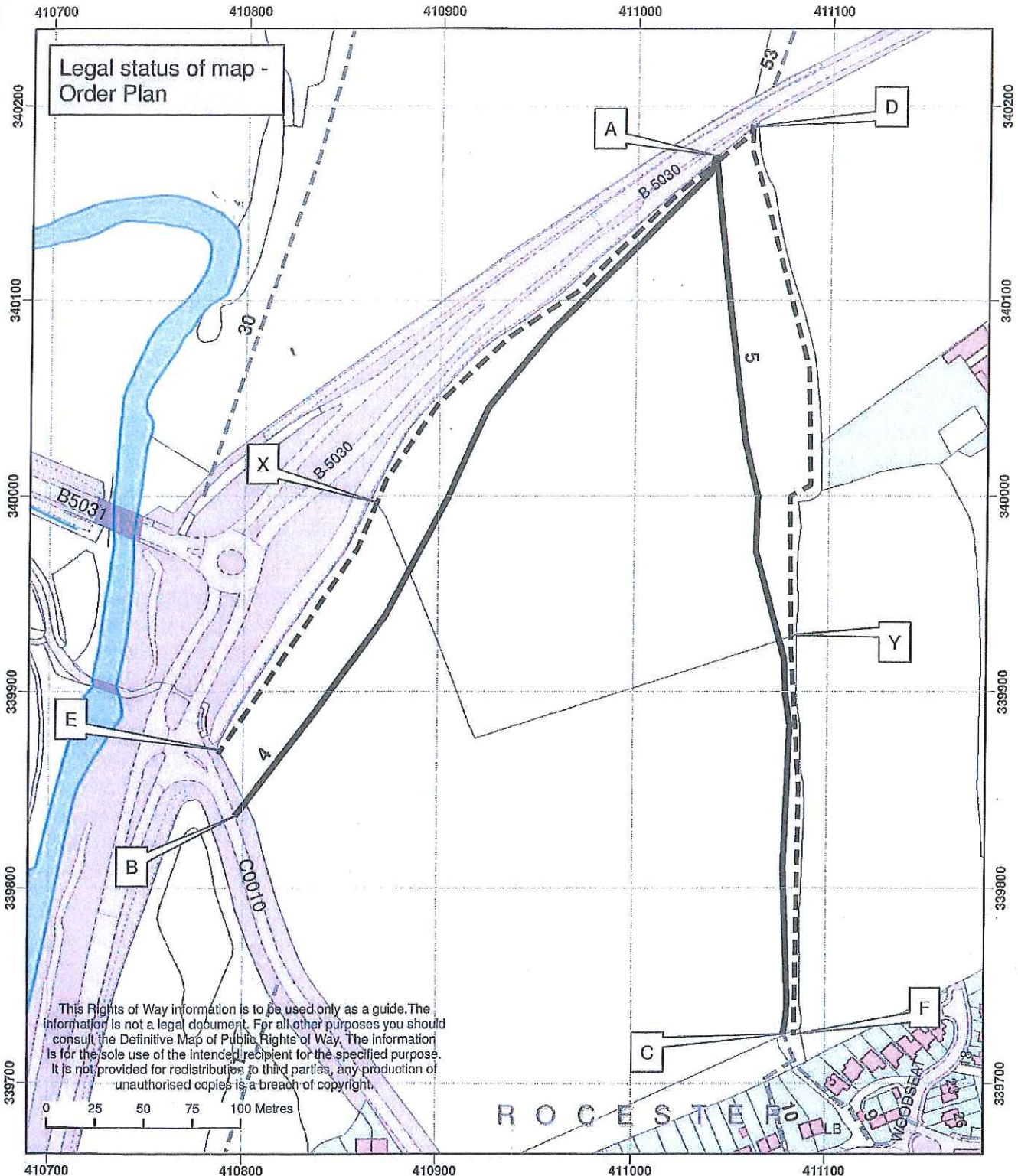

Map created at the scale of 1:2500  
 (facsimiles may vary)

© Crown Copyright and database rights 2015.  
 Ordnance Survey 100019422. You are not permitted to copy, sub-license, distribute or sell any of this data to third parties in any form. Use of this data is subject to the terms and conditions shown at [www.staffordshire.gov.uk/maps](http://www.staffordshire.gov.uk/maps). Produced by Staffordshire County Council, 19/10/2015.

- Paths to be extinguished (A - B and A - C).
- Paths to be created (D - X - E and D - Y - F).
- Rights of Way Unaffected
- Footpath